

TECHNOLOGY TRAINING CENTRE

Computer Literacy Project

Wenchi Secondary School
Wenchi, Brong Ahafo Region

TOTAL PROJECT:	¢2,417,300	\$371.89 ¹
TOTAL REQUEST:	¢1,812,975	\$278.92
SCHOOL CONTRIBUTION:	¢604,325	\$92.97

HEADMASTER: Mr. Samuel Bannerman–Mensah
TELEPHONE: (0652) 22235
EMAIL: headmaster@wess.edu.gh, joelp@wess.edu.gh
POSTAL: WESS, P.O. Box 88, Wenchi, Brong Ahafo
VOLUNTEER: Joel Parthemore

Statement of Need

Wenchi Secondary School (WESS) is located in the farming community of Wenchi, 30 km. north of Techiman on the Techiman–Wa Road. It has a population of approximately 15–20,000. Enrollment at WESS has been growing for the past two years and currently stands at 858, of whom 42% are in Form One.

The Technology Training Centre at WESS was inaugurated 1 March 1999 with the opening of a computer lab by the director general of Ghana Education Service. The volunteer became full–time with the project in September 1999. Since that time student involvement in the centre has been growing each term: this past term 322 students were enrolled in classes. The centre hired a full–time assistant in January 2000 and is looking to add a part–time assistant in September.

In April 2000 the centre received a grant through the Peace Corps Partnership Project for a variety of new equipment, including a generator, two computers, a laser printer and a UPS. An additional grant of equipment from USAID is expected in September and will include four more computers plus networking equipment and UPSs.

Unfortunately USAID has at this point removed from the budget the funds needed to extend the phone line from the administration block to the computer lab. The school has already extended itself considerably in keeping up with its obligations under the existing grants (inflation this year has been substantial, and computer equipment is all priced in US dollars), and so cannot afford the phone extension without assistance. Without the phone line, the project is not truly an Internet–oriented project (as

¹ Exchange rate of ¢6,500 to the US dollar as of 1 August 2000.

envisioned in the Peace Corps Partnership and USAID grants), and its potential for community outreach is substantially curtailed.

The other substantial thing missing from the computer lab at this point is adequate security. A large quantity of very expensive equipment is locked behind a relatively frail door. The school has security guards and has this term erected a school wall, which already substantially improves our position. However, properly speaking the computer lab should have iron bars over all the windows and an iron gate over the door. Again, the school has shown considerable commitment to date but cannot meet the need for added security without outside assistance.

Goals and Objectives

The goal of these activities is to remove the remaining substantial barriers to the opportunity for a self-sustainable computer lab and Technology Training Centre. (A separate request is being made to the Wenchi District Assembly for additional voltage stabilizers.)

The objectives are:

- To permit Web-browsing and other online activities from the inauguration of the newly expanded lab in October 2000.²
- To have adequate security measures in place by the inauguration date.

The principal beneficiaries are the students of Wenchi Secondary School; the secondary beneficiaries are the masters and staff; but, indeed, the whole community can and will come to benefit. (Already the lab has been receiving considerable numbers of requests from the community for community classes... requests which it has so far been unable to meet.)

Action Plan

Installation of the telephone extension will be done by the Wenchi Post and Telecom office. (If they prove sufficiently intractable, assistance will be sought instead from Techiman Post and Telecom.) Close supervision will be provided by the headmaster, the Peace Corps volunteer, and other masters of the school.

The Wenchi P&T claims that six spans will be required (it is not in fact clear that this is the case) as well as 20 yards of cable. The P&T will provide the materials and transportation (although a school vehicle is also available for transportation.)

With funds in hand, the work should be able to be completed within a fortnight.

Installation of the iron bars and gate will be done by Emmanuel Antwi, an electrical contractor who has already done considerable work for the school and the lab. Supervision will be provided by the Peace Corps volunteer and his assistant.

Materials required are two lengths of 5/8" iron rod, 50 lengths of 1/2" iron rod and one bag of cement. Materials will be provided by Mr. Antwi and transportation by the school.

With funds in hand, the work should be able to be completed within one week.

² Assuming a delivery date from USAID by 15 September.

Budget

All budget figures have been divided 75% SPA and 25% school contribution. (Since there are no opportunities for in-kind contributions, the school contribution represents actual monetary outlay by the school.)

Recurring costs for use of the phone line for email and web-browsing will be met primarily by student fees, currently set at ¢8,000 per student per term.

<i>Item</i>	<i>Total Cost</i>	<i>SPA Contribution</i>	<i>School Contribution</i>
Phone extension	¢561,550	¢421,162.50	¢140,387.50
5/8" iron rods (2)	58,000	43,500.00	14,500.00
1/2" iron rods (50)	1,250,000	937,500.00	312,500.00
Cement (one bag)	28,000	21,000.00	7,000.00
Workmanship	300,000	225,000.00	75,000.00
Subtotals	2,197,550	1,648,162.50	549,387.50
<i>Inflation 10%</i>	<i>219,750</i>	<i>164,812.50</i>	<i>54,937.50</i>
Totals	2,417,300	1,812,975.00	604,325.00

Monitoring and Evaluation

The implementation period is brief: the project outlined in this proposal should be complete within a fortnight and at the outside within a month. Consequently monitoring can be tightly controlled and evaluation immediate. The success of the project will be measured in the self-sustaining use of the lab for evening web browsing, and in the lack of break-ins to the facility.

Addenda

- ◆ Computer lab layout
- ◆ Pro-forma invoices
 - × Ghana Telecommunications Company Limited
 - × Emmanuel H.K. Antwi, General Electrical & Electronic Works

Computer Lab Layout

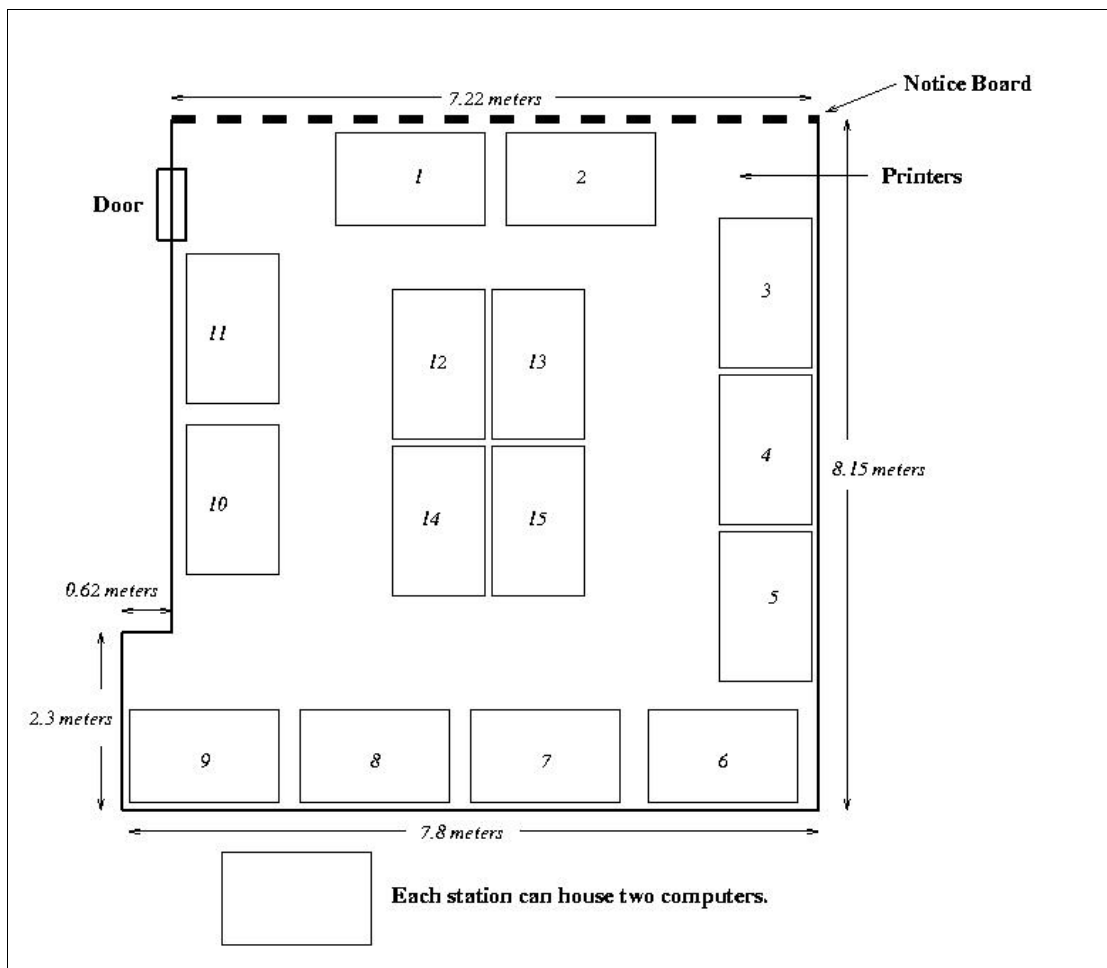

Windows are located behind tables 3, 4 and 5, and behind tables 10 and 11. Bars will be placed on the *inside* of the windows for aesthetic reasons.